



PWS-503R-PQ includes:

2 x 500W Power Modules:  
PWS-503R-1R

1 x Housing with PDB  
PDB-PT732-8824

- Dimension (W x L x H): 150 x 190 x 84 mm
- Maximum Output Power: 500W



### INPUT CHARACTERISTICS

RATED VOLTAGE / CURRENT	100-127Vac / 200-240Vac 8 - 4A
RATED FREQUENCY	50-60HZ
INRUSH CURRENT	Less than 50A
POWER FACTOR	0.95 (Typical)

### DC OUTPUT CHARACTERISTICS

OUTPUT VOLTAGE & CURRENT	Output Voltage	Min Output Current	Max Output Current
	+3.3V	0.5A	20A
+5V	0.3A	25A	
+12V	1.0A	40A	
-12V	0A	0.5A	
+5Vsb	0A	4A	
Maximum combined continuous power of 5V and 3.3V is 150W. Total maximum output power 500W.			
EFFICIENCY	80% Typical		
REGULATION	+3.3V/+5V/+12V/+5Vsb: +/-5% -12V: +/-10%		
RIPPLE & NOISE	+3.3V/+5V/+5Vsb: 50mV +12V/-12V: 120mV		
OUTPUT CONNECTOR	24pin/8pin/4pin/HDD/PCIe		
HOLD UP TIME	PWOK 15ms at max Loading Vout 16ms at max loading		

### GENERAL SPECIFICATIONS

REMOTE MANAGEMENT	N/A
MTBF	>100,000hours, 25 °C
REMOTE CONTROL	PSON signal is to remote turn ON/OFF the power supply
PROTECTION	OCP, OVP, Short Circuit, Over Temperature, Input Under Voltage

### Features and Benefits:

- Redundant Hot-swappable support
- Optimized for Workstations and Desktop Application

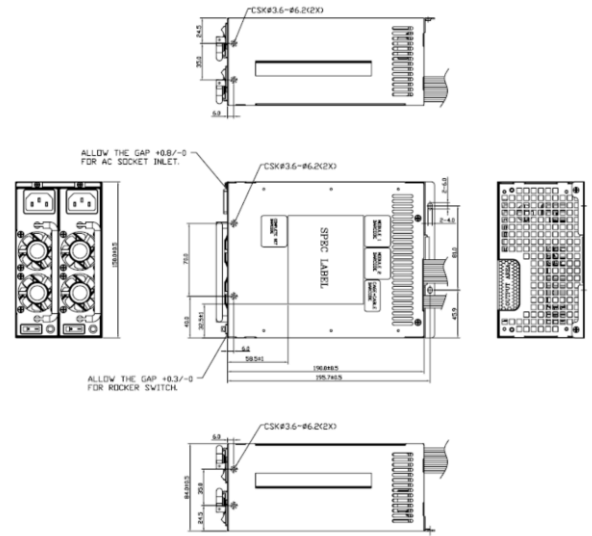

Connector Type	Cable Length (mm)
24Pin ATX	340
4+4Pin 12V	380
8Pin 12V	320
2x 4Pin Peripheral	500+200
2x 4Pin Peripheral + FDD	500+200+100
2x SATA	510+150
6pin PCIe	320
6pin PCIe	500
6+2pin PCIe	500

### REGULATORY

SAFETY & COMPLIANCE	UL60950-1/CSA 60950-1 EN60950-1 IEC60950-1 CB Report CE Low Voltage Directive BSMI CCC (2000m)
EMC	FCC/CISPR Class B

### ENVIRONMENTAL SPECIFICATIONS

AMBIENT TEMPERATURE	Operating: 0 to 50 °C Non-Operating: -20to 80 °C
OPERATING ALTITUDE	Operating: to 3000m Non-Operating: to 10580m
RELATIVE HUMIDITY	Operating: 5% to 90% (non-condensing) Non-Operating: 5% to 90% (non-condensing)

Disclaimer: Specification is subject to change without prior notice