



PWS-503R-PQ includes:

2 x 500W Power Modules:
PWS-503R-1R

1 x Housing with PDB
PDB-PT732-8824

- Dimension (W x L x H): 150 x 190 x 84 mm
- Maximum Output Power: 500W



INPUT CHARACTERISTICS

| | |
|-------------------------|-----------------------------------|
| RATED VOLTAGE / CURRENT | 100-127Vac / 200-240Vac 8 - 4A |
| RATED FREQUENCY | 50-60HZ |
| INRUSH CURRENT | Less than 50A |
| POWER FACTOR | 0.95 (Typical) |

DC OUTPUT CHARACTERISTICS

| OUTPUT VOLTAGE & CURRENT | Output Voltage | Min Output Current | Max Output Current |
|---|--|--------------------|--------------------|
| | +3.3V | 0.5A | 20A |
| +5V | 0.3A | 25A | |
| +12V | 1.0A | 40A | |
| -12V | 0A | 0.5A | |
| +5Vsb | 0A | 4A | |
| Maximum combined continuous power of 5V and 3.3V is 150W. Total maximum output power 500W. | | | |
| EFFICIENCY | 80% Typical | | |
| REGULATION | +3.3V/+5V/+12V/+5Vsb: +/-5% -12V: +/-10% | | |
| RIPPLE & NOISE | +3.3V/+5V/+5Vsb: 50mV +12V/-12V: 120mV | | |
| OUTPUT CONNECTOR | 24pin/8pin/4pin/HDD/PCIe | | |
| HOLD UP TIME | PWOK 15ms at max Loading Vout 16ms at max loading | | |

GENERAL SPECIFICATIONS

| | |
|-------------------|--|
| REMOTE MANAGEMENT | N/A |
| MTBF | >100,000hours, 25 °C |
| REMOTE CONTROL | PSON signal is to remote turn ON/OFF the power supply |
| PROTECTION | OCP, OVP, Short Circuit, Over Temperature, Input Under Voltage |

Features and Benefits:

- Redundant Hot-swappable support
- Optimized for Workstations and Desktop Application

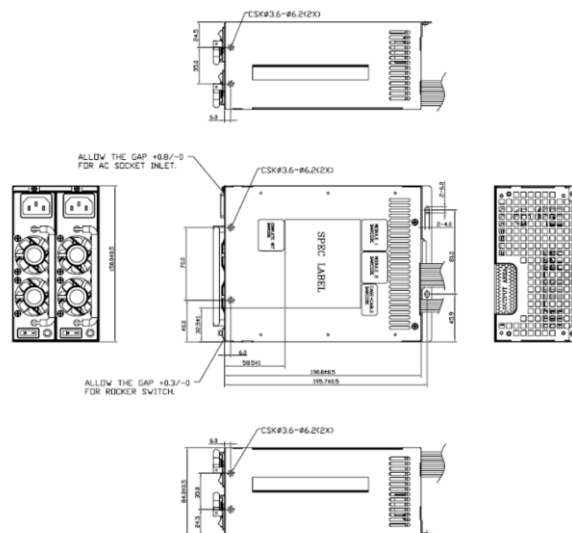

| Connector Type | Cable Length (mm) |
|--------------------------|-------------------|
| 24Pin ATX | 340 |
| 4+4Pin 12V | 380 |
| 8Pin 12V | 320 |
| 2x 4Pin Peripheral | 500+200 |
| 2x 4Pin Peripheral + FDD | 500+200+100 |
| 2x SATA | 510+150 |
| 6pin PCIe | 320 |
| 6pin PCIe | 500 |
| 6+2pin PCIe | 500 |

REGULATORY

| | |
|---------------------|--|
| SAFETY & COMPLIANCE | UL60950-1/CSA 60950-1 EN60950-1 IEC60950-1 CB Report CE Low Voltage Directive BSMI CCC (2000m) |
| EMC | FCC/CISPR Class B |

ENVIRONMENTAL SPECIFICATIONS

| | |
|---------------------|--|
| AMBIENT TEMPERATURE | Operating: 0 to 50 °C Non-Operating: -20to 80 °C |
| OPERATING ALTITUDE | Operating: to 3000m Non-Operating: to 10580m |
| RELATIVE HUMIDITY | Operating: 5% to 90% (non-condensing) Non-Operating: 5% to 90% (non-condensing) |